



IdeaShare Key (Type-C)

Tap and Share in Seconds

The IdeaShare Key (Type-C) is used with HUAWEI IdeaHub and Box series. You can share your PC or mobile phone screen in one click. It is ideal for various scenarios, including work reports and group discussions, improving work efficiency.



Plug and play



- High-speed automatic networking without connecting your PC or mobile devices to Wi-Fi.
- Fast start without any apps.

Wide compatibility



- Android, HarmonyOS, iOS, Windows, and macOS.
- PCs, mobile phones, and tablets.

Real presence

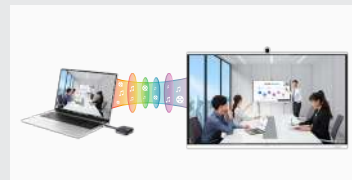

- HD projection and simultaneous transmission of images and sounds.
- 48K dual-channel lossless audio playback with outstanding sound quality.

Dual-screen collaboration

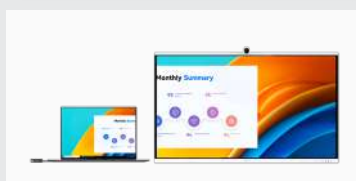

- The extended screen mode enables ultimate collaboration efficiency. Take notes on your device while projecting meetings or files onto the screen.

Reverse control

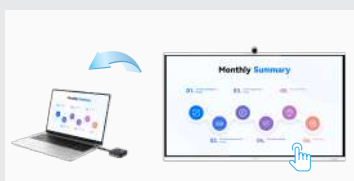

- Directly control the shared content on the large screen, such as turning pages and enabling slide show.

Trustworthy technology

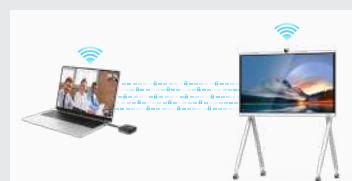

- 2.4G/5G dual-band Wi-Fi for more stable connection.
- AES256 encrypted transmission to ensure information security.

IdeaShare Key (Type-C)

Technical Specifications

System Compatibility	
Projection receiving end	HUAWEI IdeaHub Enterprise, IdeaHub Pro, IdeaHub S, IdeaHub Board Pro, IdeaHub B2, IdeaHub Board 2, IdeaHub S2, Collaboration Device Pro, Collaboration Device, Collaboration Device Lite, Box 310, and Box 610
Operating system *	Windows 、 MacOS 、 Andriod 、 HarmonyOS 、 iOS
Video Features	
Projection resolution	Up to 1080P60FPS without installing an app; up to 4K30FPS with an app installed
Audio Features	
Audio projection	48K dual-channel lossless audio
Security and Stability	
Connection distance	≤ 20 m
Data security	AES encryption
Interface	
Type	USB Type-C port (supports conversion to USB Type-A port.)
Wireless Specifications	
Protocol	IEEE 802.11 a/b/g/n.
Wi-Fi frequency	2.4 GHz and 5 GHz
Mode	Client mode
Authentication mode	WPA2-PSK authentication
Physical Specifications	
Dimensions (H x W x D)	Product dimensions: 18 mm x 154 mm x 60 mm Package dimensions: 32 mm x 175 mm x 115 mm
Net Weight	Gross weight: 162.5 g Net weight: 58.59 g
Maximum power consumption	≤ 2.5 W
Operating voltage	5V DC
Ambient temperature and humidity	Temperature: 0°C to 40°C (working state) -40°C to +70°C (non-working state) Relative humidity (non-condensing): 5% to 95% (working state) 0% to 95% (non-working state)
Certification and standards	EU CE certification and SRRC Radio Type Approval



* If the computer or endpoint does not have a Type-C port, use a USB port converter.

* The function varies with the product operating system version. Actual effect may vary.

Copyright © Huawei Technologies Co., Ltd. 2023. All rights reserved.

No part of this document may be reproduced or transmitted in any form or by any means without the prior written consent of Huawei Technologies Co., Ltd.

Trademarks and Permissions

 HUAWEI , HUAWEI ,  are trademarks or trade names of Huawei Technologies Co., Ltd. All other trademarks, names, service names, and company names mentioned in this document are the property of their respective holders.

Disclaimer

The technical specifications described in this document include but are not limited to parameters and performance indicators and vary depending on the actual release. This document does not constitute a warranty of any kind, expressed or implied. Huawei may update relevant information from time to time. Huawei reserves the right to update or correct the information about related products or solutions. Updates are described in detail in the latest release notes or introduction.

Updated: Jan, 2023

Huawei Technologies Co., Ltd.

Huawei Industrial Base, Bantian, Longgang

Tel: +86 755 28780808

Postal code: 518129

www.huawei.com